

## ScreenOut<sup>®</sup> Pro Back-to-Back 75"

Item no.: 2507

### Outdoor totem for two screens with heating and ventilation

The ScreenOut<sup>®</sup> Pro back-to-back is an outdoor totem, which is suitable for 2 screens with a screen size of 75" | 191 cm. The screens are mounted „back-to-back“. The VESA mount meets the VESA standard up to max. 400 x 400 mm, on request this can be expanded to VESA 400 x 600 mm.

The totem is made from a high-quality steel construction and supplied with 6.4 mm thick, anti-reflective laminated safety glass (VSG). The base offers space for concealed floor wiring and is accessible via a service flap. The installed components are always protected against unauthorized access and vandalism.

The ScreenOut<sup>®</sup> Eco Kiosk series includes active ventilation by high-quality industrial fans and a filter bank as standard to ensure perfect air circulation (air curtain) or filtering.

The front of the outdoor totem is manufactured according to protection standard IP65 / NEMA 4, the back according

to IP54 standard. The cabling and protection is carried out professionally according to VDE specifications (e-check). The outdoor totem is also tested according to EMC requirements and has the DGUV V3 seal of approval.

The interior dimensions offer enough space e. G. for a mini PC, Set Top Box or plug-bar.

Thanks to industrial fans, industrial heating and sensor-based temperature control the outdoor totem is suitable in an ambient temperature range from -25 up to +40° C.

The standard version is intended for permanent installation using a foundation.

Optionally, the totem can be customized in special RAL colours or with a logo.



Cabling according to VDE guidelines

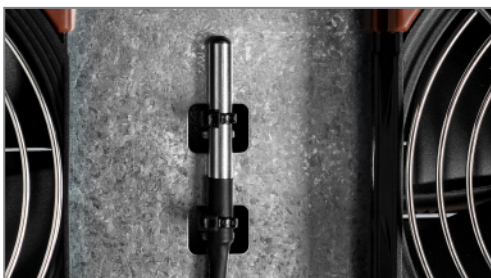

Temperature sensors



Optional individual colour design possible



\*Please note! The supernatant of the threaded rods in the existing foundation must be at least 14 cm. Technical changes reserved.  
This document is the property of HAGOR Products GmbH. Forwarding and duplication of this document, utilization and communication of its contents are not permitted unless expressly permitted.  
A violation obliges you to pay compensation. All rights reserved in the event of a patent, utility model or design registration.

## ScreenOut<sup>®</sup> Pro Back-to-Back 75"

Item no.: 2507

Outdoor totem for two screens with heating and ventilation

- for 2 screens with a size of 75" | 191 cm
- incl. VESA mount up to VESA 400 x 400 mm, optionally extensible up to VESA 400 x 600 mm
- 6.4 mm thick, antireflective laminated safety glass (LSG)
- manufactured according to:  
IP 65 / NEMA 4 and IP 54
- enough space for mini PC or Set Top Box
- impact and scratch resistant powder-coating
- standard: anthracite grey (RAL 7016), more RAL colours on request
- sensor-based temperature control
- thanks to high-quality heating and ventilation suitable for an ambient temperature range between -25° C and +40° C
- *optional:*
  - Extension of VESA standard to 400 x 600 mm
  - desired colour according to RAL (Item no.: 1664)
  - WLAN antenna (Item no.: 2515)
  - logo as film plot

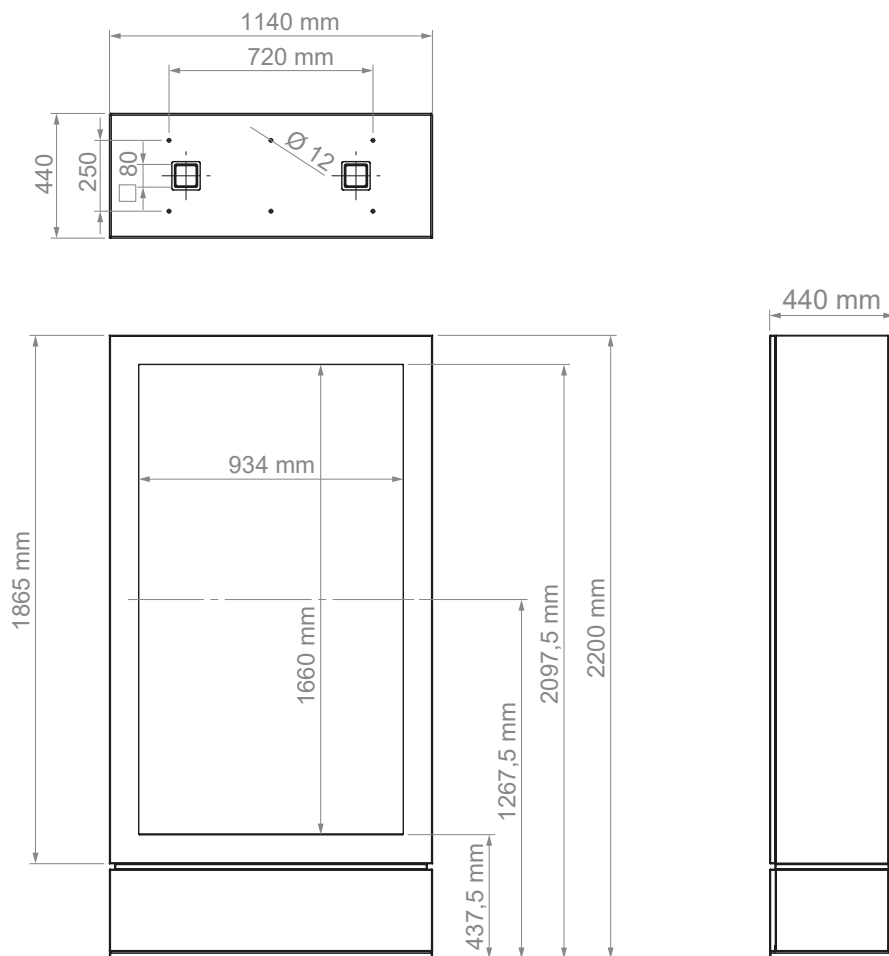

\*Please note! The supertant of the threaded rods in the existing foundation must be at least 14 cm. Technical changes reserved.  
This document is the property of HAGOR Products GmbH. Forwarding and duplication of this document, utilization and communication of its contents are not permitted unless expressly permitted.  
A violation obliges you to pay compensation. All rights reserved in the event of a patent, utility model or design registration.